

# clever

G R I F E R Í A

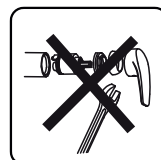
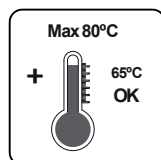
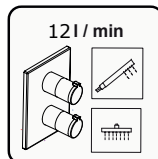
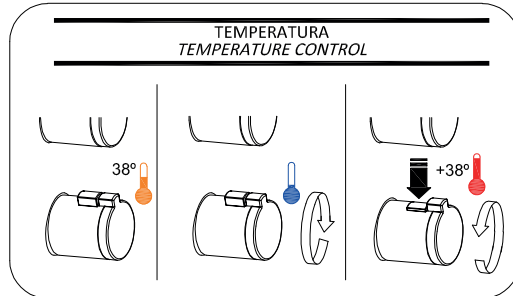
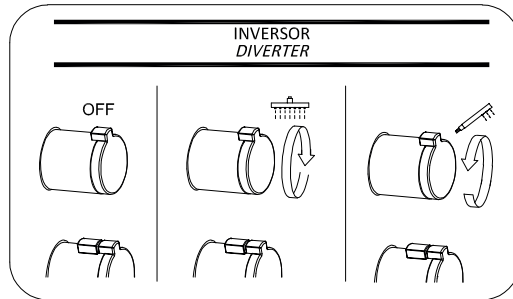

Todos los diagramas de instalación son únicamente de referencia.  
All installation diagrams are only for your reference.

# clever

G R I F E R Í A

## 1. CAJA EMPOTRADA 1. CONCEALED BOX

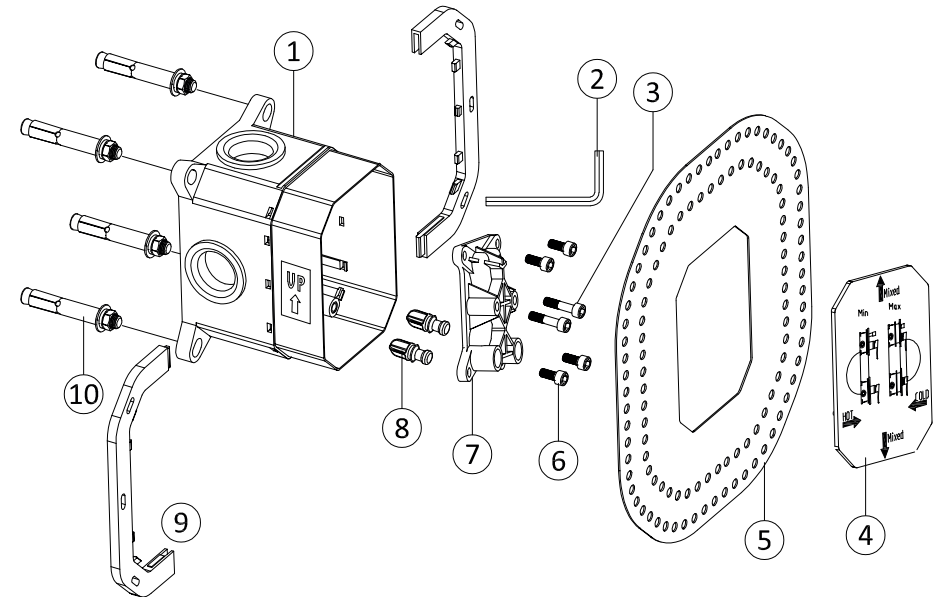

Nr.	DESCRIPCIÓN DESCRIPTION	CANT. QTY.
1	CAJA iCLEVER (4 * 1/2") iCLEVER BOX (4 * 1/2")	1
2	LLAVE HEXAGONAL ALLEN HEXAGONAL ALLEN KEY	1
3	TORNILLO ALLEN M5*45 ALLEN SCREW M5*45	2
4	PROTECCIÓN / INSTRUCCIONES PROTECTION / INSTRUCTION	1
5	JUNTA PARA TABIQUES RUBBER WALL SEAL	1
6	TORNILLO ALLEN M5*15 ALLEN SCREW M5*15	4
7	BLOQUE DE PURGA FLUSH BOARD	1
8	TAPÓN ESTANQUEIDAD SEALING PLUG	2
9	SOPORTES CAJA iCLEVER iCLEVER BOX SUPPORT	2
10	KIT TORNILLO EXPANSIÓN EXPANSION SCREW SET	4

**PREPARACIÓN ANTES DE LA INSTALACIÓN**  
**PREPARATION BEFORE INSTALLATION**

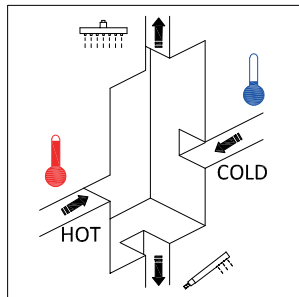

**FUNCIONALIDAD**  
**FUNCTIONALITY**

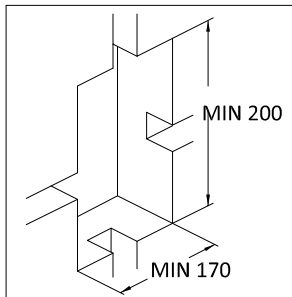

**MEDIDA ALOJAMIENTO**  
**SIZE OF THE HOLE**

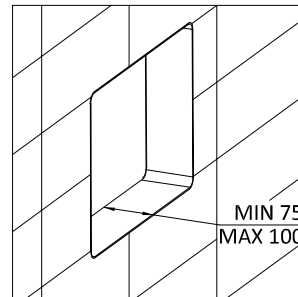

**PROFUNDIDAD TOTAL ALOJAMIENTO**  
**TOTAL DEPTH OF THE HOLE**

**GUÍA DE INSTALACIÓN**  
**INSTALLATION GUIDE**

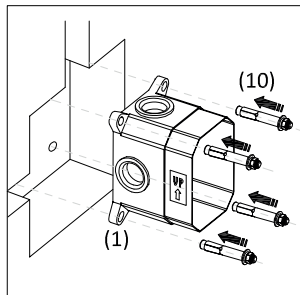

**COLOCAR LOS 4 TORNILLOS EXPANSIÓN (10) EN PARED, CON LA CAJA (1) COMO REFERENCIA**  
**PUT THE 4 EXPANSION SCREW (10) IN THE WALL TAKING AS REFERENCE THE iCLEVER BOX (1)**

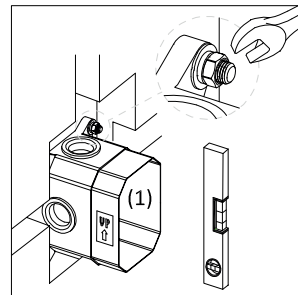

**MONTAR LA CAJA iCLEVER (1) Y COMPROBAR LOS NIVELES RESPECTO LA PARED**  
**FIX THE iCLEVER BOX (1) AND ADJUST THE LEVELS WITH REGARD TO THE WALL**

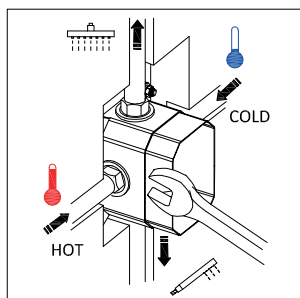

**CONECTAR LOS TUBOS DE ENTRADA Y LOS DE SALIDA**  
**CONNECT THE WATER PIPES INLETS AND WATER PIPES OUTLETS**

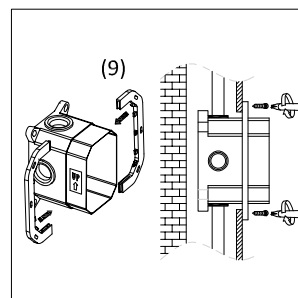

**MONTAR LOS 2 SOPORTES (9) SI LA PARED NO ES SÓLIDA. FIJAR LA CAJA iCLEVER MEDIANTE TORNILLOS**  
**ASSEMBLE 2 SUPPORTS (9) IF THE WALL ISN'T SOLID FIX THE iCLEVER BOX WITH SELF TAPPING SCREWS**

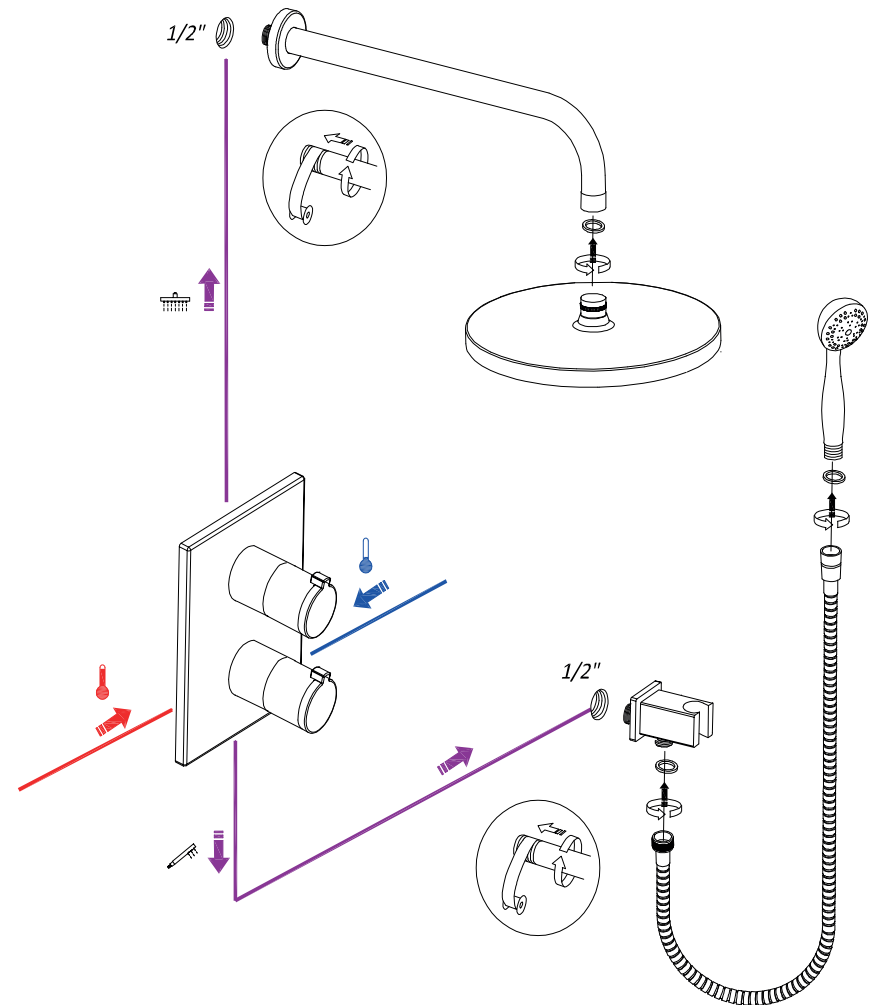

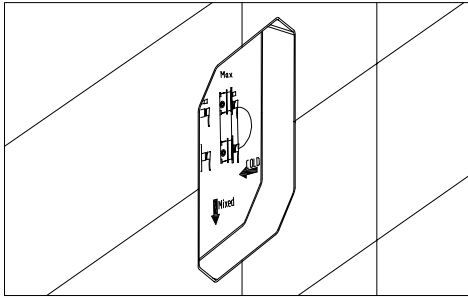

ESTA GRIFERIA SOLAMENTE PUEDE SER INSTALADA UNA VEZ SE HAYA INSTALADO LA CAJA. PARA LA INSTALACIÓN DE DICHA CAJA, CONSULTE LA GUÍA DE INSTALACIÓN DE LA CAJA "IM-BOXSHOWER2"

*THIS CONTROL VALVE CAN BE INSTALLED ONLY ONCE THE BOX HAS BEEN INSTALLED. FOR THE INSTALLATION OF THE BOX, PLEASE REFER THE INSTALLATION GUIDE NAMED "IM-BOXSHOWER2"*

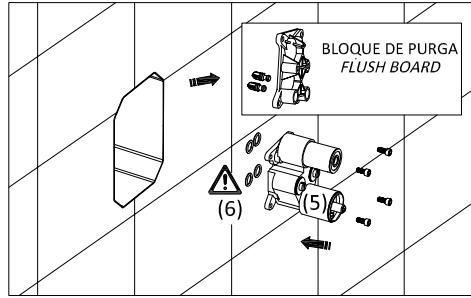

CERRAR EL SUMINISTRO DE AGUA Y QUITAR EL BLOQUE DE PURGA. COLOCAR LA GRIFERIA (5) DENTRO DE LA CAJA Y ROSCARLA MEDIANTE LOS 4 TORNILLOS QUE SUJETABAN EL BLOQUE DE PURGA -ASEGURARSE QUE LAS 4 JUNTAS (6) ESTÁN MONTADAS EN LA BASE



*STOP THE WATER SUPPLY AND DISSASSEMBLE THE FLUSH BOARD. PUT THE CONTROL VALVE BODY (5) INTO THE BOX AND FIX IT BY TIGHTENING THE 4 SCREW WHICH WERE ASSEMBLED BEFORE.*



*MAKE SURE TO PUT ALL THE 4 PIECES OF SEALING O-RING (6)*

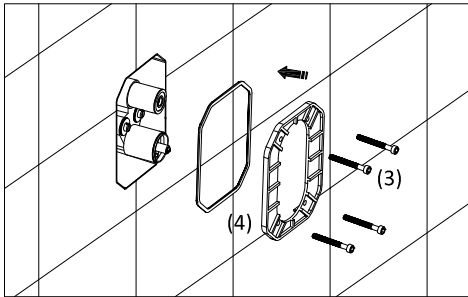

COLOCAR EL PLAFÓN DE SELLADO CON SU JUNTA (4) Y FIJARLA CON LOS 4 TORNILLOS ALLEN (3). ASEGURARSE QUE EL PLAFÓN (4) ESTÉ BIEN POSICIONADO ANTES DE APRETAR LOS 4 TORNILLOS (3)

*PUT THE PLASTIC GASKET WITH THE SEALING RING (4) AND FIX IT WITH 4 ALLEN SCREW (3). PLEASE ADJUST THE PLASTIC GASKET (4) IN THE RIGHT POSITION BEFORE TIGHTENING THE SCREWS (3)*

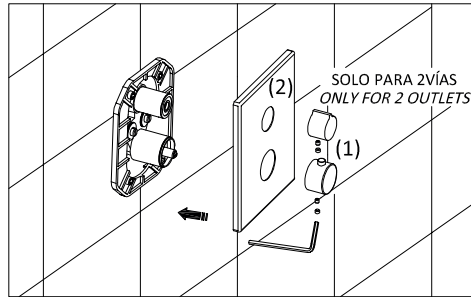

COLOCAR EL FLORÓN CROMADO (2) Y LAS MANETAS (1) MEDIANTE LA LLAVE ALLEN. FINALMENTE MONTAR EL ÍNDICE.

*INSTALL THE CHROME PLATE (2) AND HANDLE SET (1) BY TIGHTENING THE SMALL ALLEN SCREW. FINALLY PUT THE INDEX*

## COMPROBACIÓN FUGAS TESTING PROCEDURE

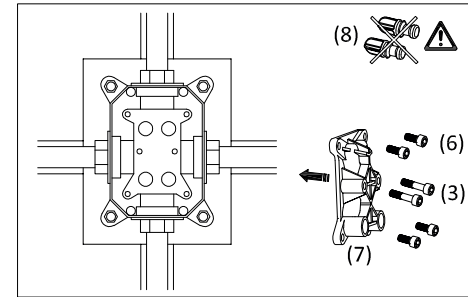

MONTAR EL BLOQUE DE PURGA (7) MEDIANTE LOS TORNILLOS (3) (6)  
*ASSEMBLE THE FLUSH BOARD (7) BY THE SCREWS (3) (6)*

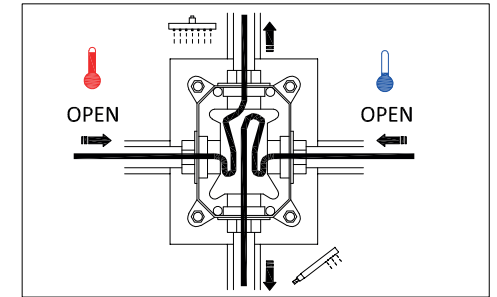

ABRIR EL SUMINISTRO DE AGUA FRIA Y CALIENTE Y COMPROBAR QUE NO HAYA NINGUNA FUGA EN LAS CONEXIONES REALIZADAS  
*OPEN THE WATER SUPPLY AND CHECK THERE ISN'T LEAKING FROM ANY OUTLET CONNECTION PART*

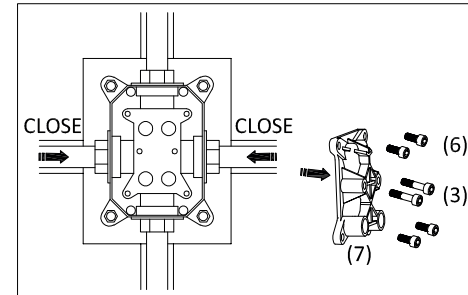

CERRAR EL SUMINISTRO DE AGUA Y SACAR EL BLOQUE DE PURGA (7).  
*CLOSE THE WATER SUPPLY AND REMOVE THE FLUSH BOARD (7).*

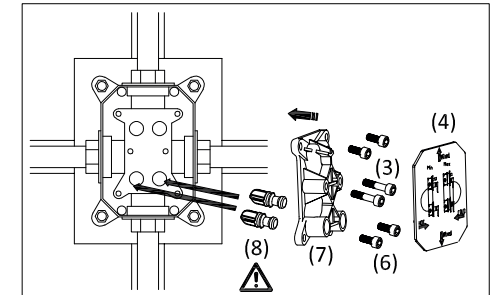

VOLVER A MONTAR EL BLOQUE DE PURGA (7), PERO ESTA VEZ CON LOS TAPONES (8) DENTRO. PONER LA PROTECCIÓN (4)  
*CAJA PREPARADA PARA EL SIGUIENTE PASO: SELLADO DE PARED*  
*ASSEMBLE AGAIN THE FLUSH BOARD (7), THIS TIME WITH THE SEALING PLUG (8) INSIDE. PUT THE PROTECTION (4).*  
*ICLEVER BOX READY FOR NEXT STEP: SEALING WALL.*

**SELLADO DE PARED**  
**SEALING WALL**

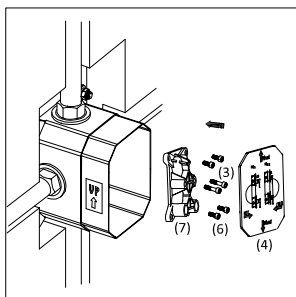

DEJAR MONTADO EL BLOQUE DE PURGA (7),  
LOS 6 TORNILLOS (3,6) Y LA PROTECCIÓN (4)  
*MUST BE ASSEMBLED THE SEALING BOARD (7)  
THE 6 SCREWS (3,6) AND PROTECTION (4)*

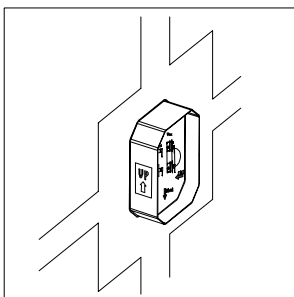

ASEGURARSE QUE NO HAN EXISTIDO  
FUGAS INTERNAS Y SELLAR CON CEMENTO.  
*MAKE SURE THERE ISN'T INNER LEAKING  
AFTER TESTING AND SEAL WITH CEMENT*

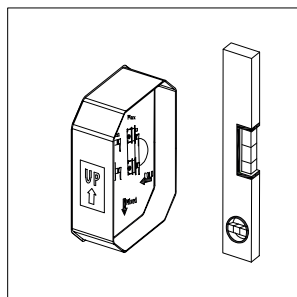

COMPROBAR NIVELES RESPECTO PARED  
DESPUÉS DE SELLAR CON CEMENTO.  
*ADJUST THE LEVELS OVER THE WALL  
AFTER SEALING WITH CEMENT*

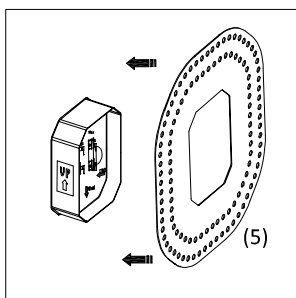

PEGAR LA JUNTA PARA TABIQUES (5)  
ALREDEDOR DE LA CAJA iCLEVER  
*GLUE THE RUBBER WALL SEAL (5)  
AROUND THE iCLEVER BOX*

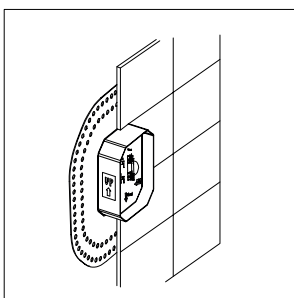

AZULEJOS: AJUSTARLOS AL MÁXIMO  
RESPECTO AL PERFIL DE LA CAJA iCLEVER (\*)  
*TILE: TRY TO NARROW THE GAP  
WITH REGARD TO iCLEVER BOX PROFILE (\*)*

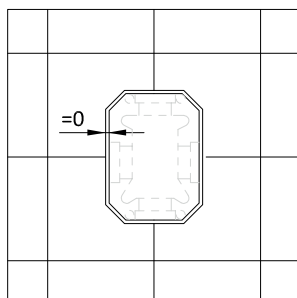

(\*) ES MUY IMPORTANTE PARA CUANDO  
VAYAMOS A MONTAR EL GRIFO  
*(\*) IT'S CRITICAL FOR INSTALLING  
THE CONTROL VALVE LATER*

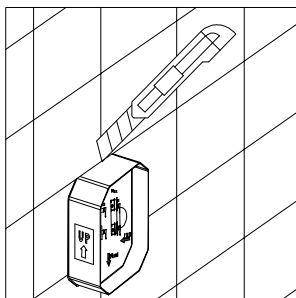

REALIZAR EL CORTE DEL PERFIL  
SOBRANTE DE LA CAJA iCLEVER  
*CUT THE PROTRUDING PART OF  
THE iCLEVER BOX*

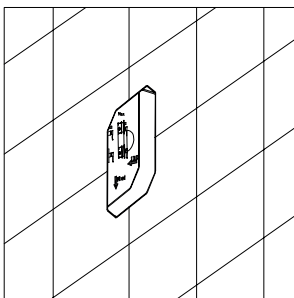

INSTALACIÓN DE LA CAJA iCLEVER FINALIZADA  
PREPARADO PARA EL MONTAJE DEL GRIFO  
*HAVE FINISHED THE iCLEVER BOX INSTALLATION  
READY TO ASSEMBLE CONTROL VALVE*

**2. VÁLVULA TERMOSTÁTICA**  
**2. THERMOSTATIC VALVE**

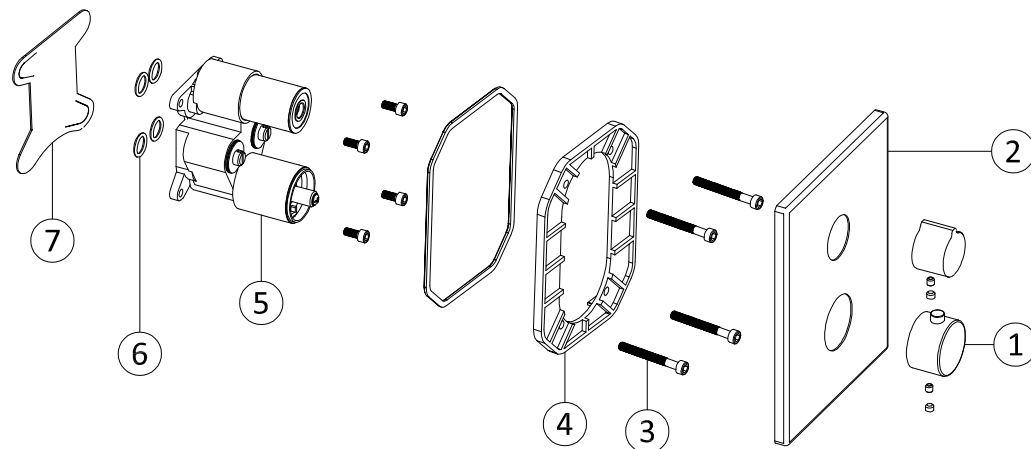

Nr.	DESCRIPCIÓN DESCRIPTION	CANT. QTY.
1	MANETA HANDLE	2
2	FLORÓN CROMADO CHROMED PLATE	1
3	TORNILLO ALLEN M5 ALLEN SCREW M5	4
4	PLAFÓN DE SELLADO SEALING PLASTIC GASKET	1
5	CUERPO GRIFERÍA CONTROL VALVE BODY	1
6	JUNTA TÓRICA O-RING	4
7	PROTECCIÓN PROTECTION	1